

## PRINCESS ROYAL STAND

## PRINCESS ROYAL SUITE

The Princess Royal Suite is located on the fourth floor and accommodates up to 350 delegates theatre style. It can be split into two separate suites and offers stunning views of the racecourse.



THEATRE

350



BOARDROOM

50



CABARET

220



CLASSROOM

180



DINNER

300



DINNER DANCE

250



U SHAPE

-



RECEPTION

300



13A SOCKET

USEABLE SPACE DIMENTIONS

CEILING HEIGHT 3.4M

FLOOR PLAN

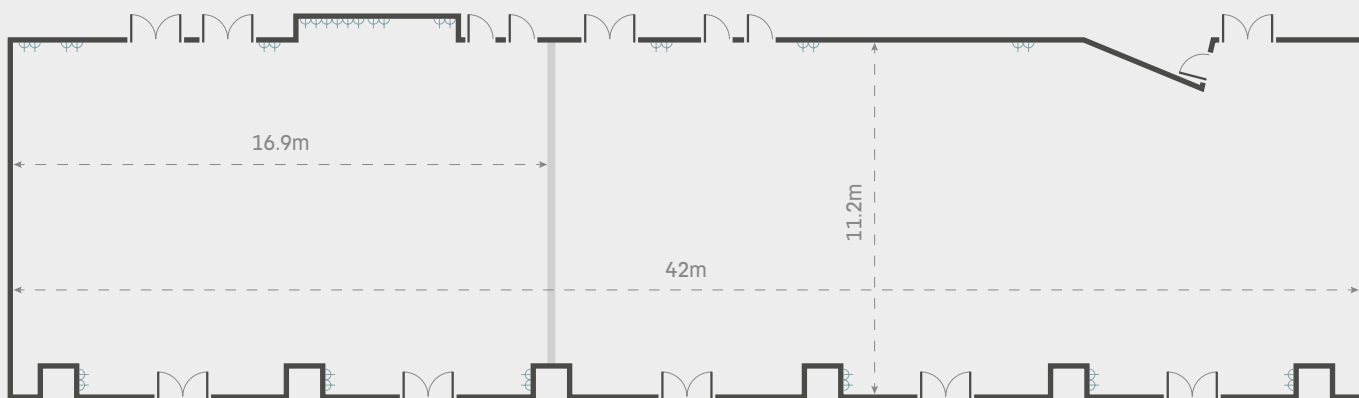

CONTACT US ON: 0151 522 2922 | NORTHWESTEVENTS@THEJOCKEYCLUB.CO.UK